

Where is the beam splitter in the hallway

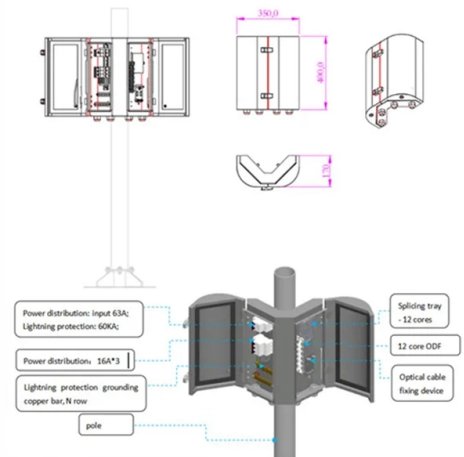

Overview

A beam splitter or beamsplitter is an optical device that splits a beam of light into a transmitted and a reflected beam. It is a crucial part of many optical experimental and measurement systems, such as interferometers, also finding widespread application in fibre optic telecommunications. DesignsIn its most common form, a cube, a beam splitter is made from two triangular glass which are glued together at their base using polyester,, or urethane-based adhesives. (Before these synthetic. Beam splitters are sometimes used to recombine beams of light, as in a. In this case there are two incoming beams, and potentially two outgoing beams. But the amplitudes. For beam splitters with two incoming beams, using a classical, lossless beam splitter with E_a and E_b each incident at one of the inputs, the two output fields E_c and E_d are linearly related to the inputs thro.



Article Content

Beam Splitters - optical power splitter, beamsplitter, thin

Beam splitters are devices for splitting a laser beam into two or more beams. There are different types, including polarizing and non-polarizing versions.

The Buyer's Guide to Beam Splitters | Blue Ridge Optics

Matching the beam splitter's specifications to the characteristics of the light source ensures optimal performance. This minimizes light losses and aberrations while maintaining the

Photonics 101

As the name suggests, a beam splitter refers to an optical device which is used to split or divide a beam of light into two. A beam splitter is usually the cornerstone of most interferometers.

Beam Splitter

A beam splitter is defined as an optical device that effects a linear transformation of fields presented at two input ports, producing output beams that are related to the input fields in a characteristic manner

How Does a Beam Splitter Work?

Discover how beam splitters precisely divide light, exploring their fundamental optical principles, diverse designs, crucial performance aspects, and wide-ranging real-world applications.

What is a Beam Splitter, and What are Its Functions and

In the intricate realm of optics, a beam splitter stands as a fundamental and versatile optical component. It plays a pivotal role in

What Is a Beam Splitter and How Does It Work?

Pellicle Beam Splitter The Pellicle Beam Splitter uses an extremely thin membrane of optical film stretched over a frame. Because the film is only a few micrometers thick, this design

What are Beamsplitters?

Optical components that create two beams by splitting incident light are beamsplitters. Read more about the different types of beamsplitters at Edmund

Beam Splitter 101

So, what exactly IS a beamsplitter? A beamsplitter, or beam splitter, is a piece of glass with a specialized mirror coating that reflects AND transmits light at the

Beam Splitter 101

If your beam splitter is polarized, it will be taking unpolarized lighting and splitting it into two orthogonally polarized beams. This basically means that it's splitting it

Beamsplitter lenses

When integrated into specialised lenses, the beam splitter divides the incoming light into two paths: one beam illuminates the object, while the other is used for image

What is a Beam Splitter: Types And Applications

A beam splitter is a device used to separate or combine light. It is widely used in guiding light in optical systems, enhancing imaging and

Covering the Basics of Beamsplitters — Firebird Optics

What are Beamsplitters? Beamsplitters (also known as beam splitters or power splitters) are an optical component used to split an incident beam of

Beam Splitters: Types and Applications

Beam splitters find their application in a diverse array of fields, from teleprompters to robotics, impacting various technologies we rely on daily. These unassuming

What is a Beam Splitter?

A beam splitter or power splitter is an optical device that can split an incident light beam e.g. a laser beam into two or sometimes more beams, which may or may not have the same optical

Do You Know How to Place and Use the Optical Splitter?

In the realm of optical communication networks, the optical splitter serves a vital role in dividing and distributing optical signals efficiently. Understanding how to properly place and use an

Do You Know How to Place and Use the Optical Splitter?

When employing the first-level splitting method in a residential network, optical splitters offer flexibility for indoor or outdoor installation. Indoor options encompass locations like the

How Beamsplitters Work: Types, Mechanisms, and

This article explains the working principles of beamsplitters, detailing how they divide a beam of light into two separate paths, the different types of

All You Need to Know About Beam Splitters

Beam splitters are also key in interferometry. They separate a single beam into two parts, with one reflecting off of a surface. By merging the reflected

Parameters of Beam Splitter

Article introduces the meaning of the basic parameters of beam splitter. Beam splitter at specific angles, creating arrayed beams, spot size on

Beam splitters

A beam splitter works like a mirror that transmits part of the light. So there is always part of light that goes directly through without changing the direction. The rest

How does a beam splitter work? Common types and use cases

Beam splitters are essential optical components used to divide a beam of light into two or more separate beams. They play a crucial role in various scientific, industrial, and everyday

Understanding Beamsplitters: Types, Principles, and

This article explores the fundamental principles and diverse applications of beamsplitters, detailing their different types and uses in fields such as optics

Precision Beamsplitters & Quad-Channel Imaging

A beam splitter (or beamsplitter) is an optical component used to split incident light into two separate beams, typically based on wavelength or polarity. This precise

What Are Optical Beamsplitters? | Plate, Cube & Dichroic Types

In Summary Optical beam splitters are versatile devices, typically made of glass, used in separating or combining light beams. These optical components play a major role in the science and tech industry.

Contact Us

For more information, pricing, or custom solutions, please contact us:

Website: <https://www.fivesunsecoenergy.fr>

Email: sales@fivesunsecoenergy.fr

Phone: +33 6 41 83 57 29

Address: 5 Rue de la Bourse, 75002 Paris, France

This document is for informational purposes only. Specifications subject to change without notice.

